

Why use Real Rain Screen™ siding?

Real Rain Screen™ siding is beautiful, durable, easy to install and maintenance-free*. Many choices are available for color preference and our RealWood™ hardwood lumber is rated to last a lifetime – 40 to 100 years. Our signature H-clip and siding profile system makes installation easy and our siding requires no maintenance to maintain its durability.

Real Rain Screen™ siding also provides better protection from mold causing moisture than other construction methods. Over the past two decades, moisture damage to buildings has caused insurance rates to increase significantly. Some insurers have considered requiring rain screen siding to curtail ever-escalating claims caused by moisture damage. Moisture damage is most often caused by poor installation of conventional siding and window openings.

British Columbia, Canada already requires rain screen siding over conventional siding on all new construction. Rain screen siding has become more widely used in Europe and Canada in recent decades. This interest and further study compelled HUD to publish a circular, "Moisture Resistant Homes", which recommends rain screen exterior construction because it protects against moisture build up so efficiently. This is especially important in more humid climates.

* Finish application required for color maintenance but not to maintain durability.



Photo courtesy of Hufft Projects www.hufft.com

Look for the **RealWood™** tag to be sure that you're buying **PREMIUM** genuine hardwood siding.



These tags ensure that you are buying the species providing the most beautiful and the most rot and insect resistant siding **IN THE WORLD.**



Photo courtesy of Hufft Projects www.hufft.com

For more information visit:
www.BrazilianWoodDepot.com
www.RealWood.org
www.RealRainScreen.com
www.RealWoodDepot.com



Real Rain Screen RealIpe® siding

GO TM Natural

Premium Hardwood Real Rain Screen™ Siding

Real wood

Unsurpassed durability and beauty

Naturally resistant to rot and decay

Little or no maintenance required

RealIpe™

Real Wood: A Recyclable, Renewable Resource • www.RealWood.org

RealTigerwood™

Real Wood: A Recyclable, Renewable Resource • www.RealWood.org

RealCumaru™

Real Wood: A Recyclable, Renewable Resource • www.RealWood.org

RealGarapa™

Real Wood: A Recyclable, Renewable Resource • www.RealWood.org

RealMasaranduba™

Real Wood: A Recyclable, Renewable Resource • www.RealWood.org

RealMahogany™

Real Wood: A Recyclable, Renewable Resource • www.RealWood.org

RealJatoba™

Real Wood: A Recyclable, Renewable Resource • www.RealWood.org

RealWood™ hardwood is the best siding choice.

Premium RealWood™ hardwood provides unsurpassed durability and beauty. Harvested in the Central and South Americas, RealWood™ hardwood is naturally resistant to rot and decay. No pressure-treating with protective chemicals is required. Conventional pressure treated siding requires annual maintenance to retain its termite protection and resistance to rot and decay. Softer woods like oak, redwood and pine are not as resistant to weather and rot and are easily eaten by bugs. Because it is naturally resistant, RealWood™ hardwood remains maintenance-free*.

Ipe' (Brazilian Walnut) is olive brown to dark brown and one of the hardest woods on the planet. This is an extremely popular wood for decking, siding and other outdoor applications in the United States, Europe, Asia and South America.

Tigerwood is light maple color quickly weathering to reddish brown with black "tiger stripes". It is harder than any other domestic species.

Garapa is honey-yellow with a slight ribbon aspect that becomes honey brown with age.

Cumaru Rosa (Red) is extremely hard like ipe'. The cherry color offers a pronounced grain pattern with more consistent color than yellow or champagne cumaru.

Masaranduba (Brazilian Redwood) is plum colored with a very subtle grain demarcation. This hardwood is very hard and durable.

Jatoba (Brazilian Cherry) is salmon colored when freshly milled turning dramatically to a deep red very quickly in sunlight.



Photo courtesy of Hufft Projects www.hufft.com



Photo courtesy of Hufft Projects www.hufft.com



Real Rain Screen™ installation requires furring strips fastened to exterior walls over a vapor barrier. Siding is fastened to furring strips – most commonly with 16" centers. Our coated aluminum H-clips are installed using our coated and galvanized steel square drive screws. This installation provides channels in the walls, which allow the siding to breathe eliminating moisture and minimizing thermal transfer.

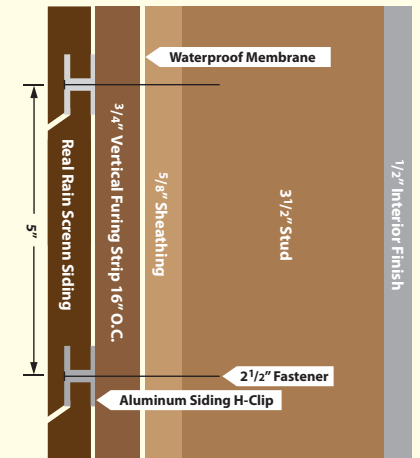

Visit www.RealRainScreen.com for more information on this renewable, sustainable resource.

The use of natural materials for exterior construction helps to reduce non-biodegradable waste accumulation while providing an oasis for outdoor enjoyment.

* Finish application required for color maintenance but not to maintain durability.